

**ALIGN**  
by Maria Berntsen

**ALIGN**  
by Maria Berntsen

**ALIGN**  
by Maria Berntsen

With her own design studio in Copenhagen, Maria Berntsen has since 1992 focused on architecture and design.

Maria Berntsen is a well-established name in the design industry, and has over the years collaborated with a wide range of Danish and international companies, where her extensive experience has resulted in many successful designs.

"At the start of a new project, I look for an idea with nerve, functionality and identity. By modeling and visualizing, I test the idea, how it might be used, and its presence."

Good design communicates and establishes a dialogue with the receiver. Design is not just about functionality – it is as much about the emotional connection and impact. To me, success is when my design brings joy in the everyday lives of people!

*Maria Berntsen*  
Maria Berntsen

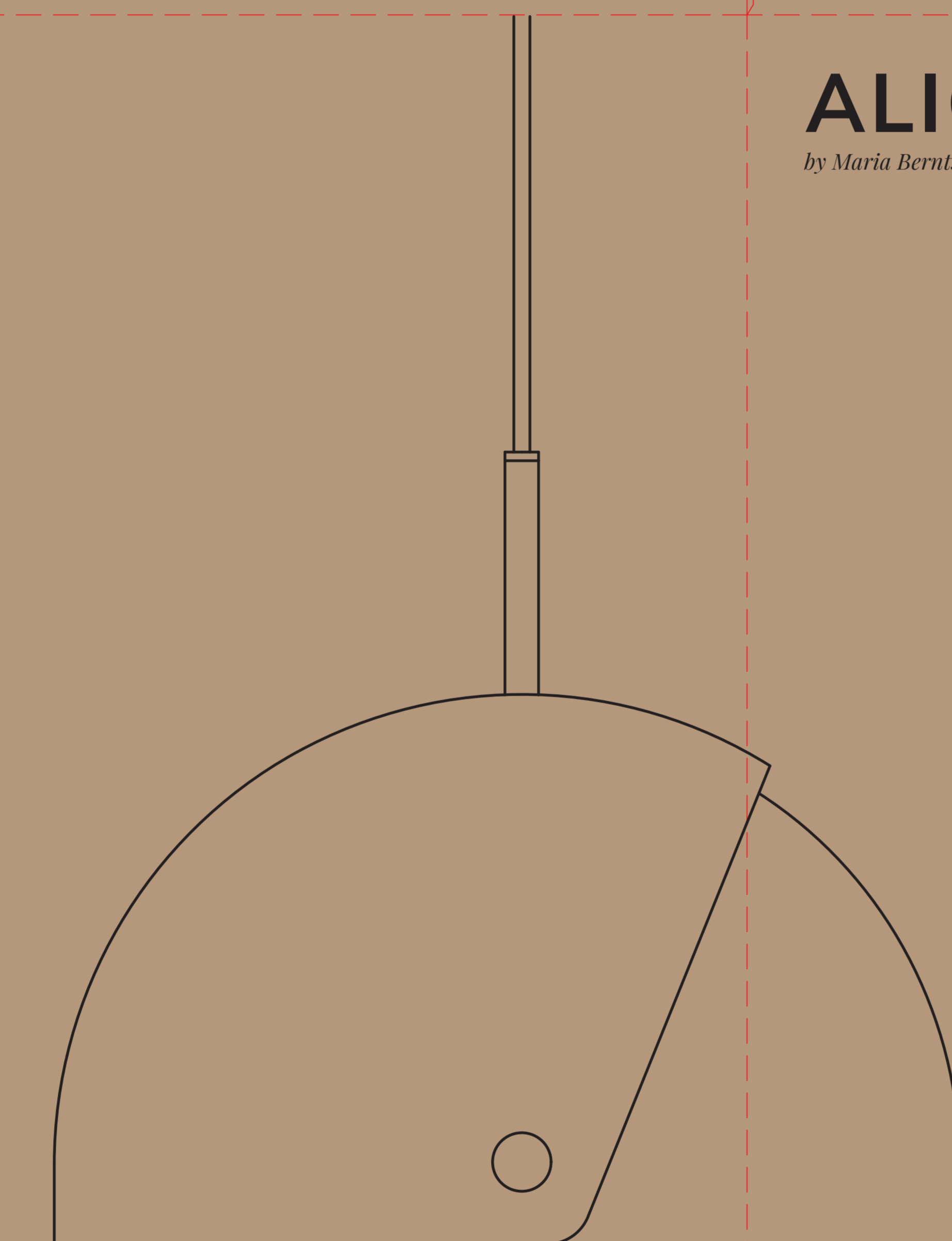

**ALIGN**  
by Maria Berntsen

Item number 2320053003  
 Color Black  
 Material Metal / Plastic  
 IP Class IP20-For indoor use, Class II  
 Voltage 220-240V~50/60Hz  
 Cable Textile cable, Black 300 cm, non-replaceable  
 Light source E27, Max. 15W, Excl. light source

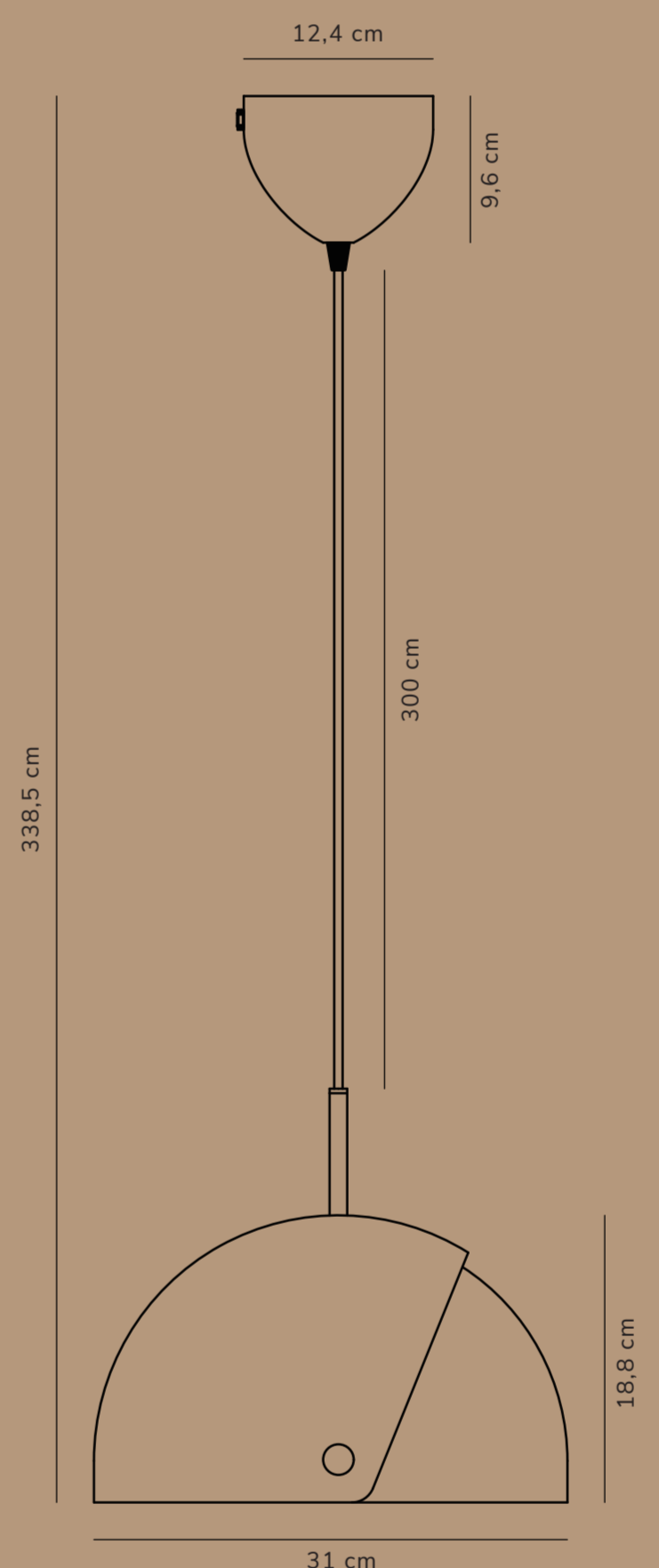
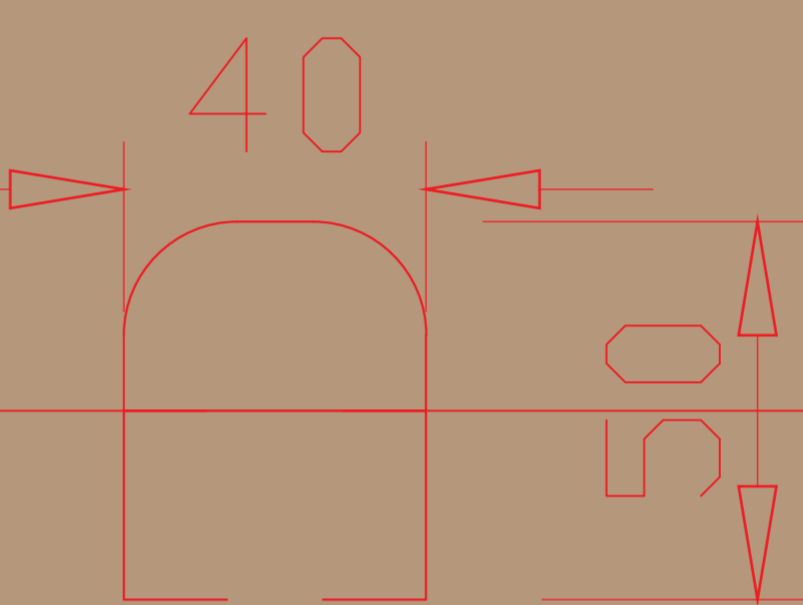

NET WEIGHT	1.100 kg
GROSS WEIGHT	1.100 kg
NET VOLUME	0.010 m <sup>3</sup>
GROSS VOLUME	0.010 m <sup>3</sup>

130

132

745

260

330

155

230

330

230

330

30

1150